

PRONTO

0.5 W - 250 W power probes with touchscreen controls



KEY FEATURES

- **POCKET-SIZE**
This mid to high power laser probe is so compact it fits in your pocket!
- **EASY TO USE**
The color LCD touchscreen allows for a friendly user interface. You can make a measurement with just the touch of a button!
- **DATA LOGGING**
Save your data to the internal memory and then transfer them to your PC over the USB connection.
- **FROM LOW TO HIGH POWERS**
Thanks to a low noise level and high damage threshold, the PRONTO can measure powers from 0.5 W to 250 W.
- **YAG AND CO₂ CALIBRATIONS**
The PRONTO-250 comes fully calibrated: every wavelength between 248 nm and 2.5 μm (YAG), and a real calibration at 10.6 μm (CO₂).

The PRONTO-250-PLUS has an additional calibration for Single-Shot Energy measurements.

- **HANDS-FREE OPERATION**
Place it on a flat surface or use one of the 2 threaded holes for safe use with optical stands.
- **SERIAL COMMANDS**
Serial commands are available to let you take full control of your PRONTO from your PC.

USER INTERFACES (SSP MODE)

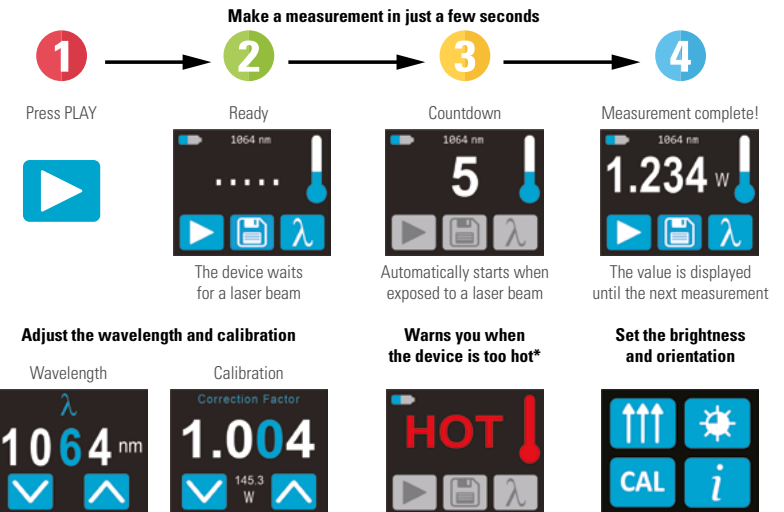

* Device may get hot, it is not recommended for handheld use when making a measurement

3 MODELS FOR ALL YOUR MEASUREMENT NEEDS

- **PRONTO-250**
PRONTO-250 is very easy to use and will give you accurate one shot measurements, thanks to its unique measurement mode:
 - Single shot power (SSP): up to 250 W
- **PRONTO-250-PLUS**
PRONTO-250-PLUS comes with 3 measurement modes and can be used in a variety of applications:
 - Single shot power (SSP): up to 250 W
 - Continuous power (CWP): up to 8 W
 - Single shot energy (SSE): up to 25 J
- **PRONTO-50-W5**
This model has our proprietary absorber with extremely high damage thresholds to handle tightly focused beams without damaging the absorber.
 - Single shot power (SSP): up to 50 W

CONNECTIVITY





HANDS-FREE



DATA TRANSFER TO PC



	PRONTO-250	PRONTO-250-PLUS	PRONTO-50-W5		
		SSP Mode Measures in 5 s	CWP Mode Measures power continuously	SSE Mode Measures in less than 0.5 s	
MAX AVERAGE POWER/ENERGY	250 W	250 W	8 W	25 J (up to 150 J for pulses >1 ms)	50 W
EFFECTIVE APERTURE	19 mm ϕ	19 mm ϕ			19 mm ϕ
INTERFACE	Touchscreen color LCD display	Touchscreen color LCD display			Touchscreen color LCD display
MEASUREMENT CAPABILITY					
Spectral range	0.19 - 20 μm	0.19 - 20 μm			0.19 - 10 μm
Calibrated spectral range	0.248 - 2.5 μm and 10.6 μm	0.248 - 2.5 μm and 10.6 μm			0.248 - 2.5 μm
Noise equivalent power/energy	10 mW	10 mW	10 mW	60 mJ	4 mW
Minimum measurable power/energy	0.5 W	0.5 W	0.2 W	N/A	0.5 W
Exposure time	5 s	5 s	1.5 s response time	0.26 s	5 s
Measurement accuracy	$\pm 3\%$	$\pm 3\%$	$\pm 2.5\%$	$\pm 5\%$	$\pm 3\%$
Min repetition period (Max pulse width)	N/A	N/A	N/A	4 s (88 ms)	N/A
Display resolution	1 mW	1 mW	1 mW	10 mJ	1 mW
DAMAGE THRESHOLDS					
Maximum average power density^a	45 kW/cm ² (at 1064 nm, 10 W, CW) 14 kW/cm ² (at 10.6 μm , 10 W, CW)	45 kW/cm ² (at 1064 nm, 10 W, CW) 14 kW/cm ² (at 10.6 μm , 10 W, CW)			100 kW/cm ² (at 1064 nm, 10 W, CW)
Maximum exposure time^b	6 s	6 s	N/A	N/A	6 s
Maximum device temperature^b	65°C	65°C	40°C	40°C	65°C
USER INTERFACE					
Measurement controls	Wavelength selection and user calibration	Wavelength selection and user calibration			Wavelength selection and user calibration
Measurement modes	Single Shot Power (SSP)	Single Shot Power (SSP), Continuous Power (CWP) and Single Shot Energy (SSE)			Single Shot Power (SSP)
Data acquisition and transfer	Yes	Yes			Yes
GENERAL SPECIFICATIONS					
Display type	Touchscreen color LCD	Touchscreen color LCD			Touchscreen color LCD
Display size	28.0 x 35.0 mm (128 x 160 pixels)	28.0 x 35.0 mm (128 x 160 pixels)			28.0 x 35.0 mm (128 x 160 pixels)
Data storage	50 000 pts	50 000 pts			50 000 pts
Battery type	Rechargeable Li-ion	Rechargeable Li-ion			Rechargeable Li-ion
Battery life	17 hours or 4 200 measurements (with brightness set at 25%)	17 hours or 4 200 measurements (with brightness set at 25%)			17 hours or 4 200 measurements (with brightness set at 25%)
Battery recharge via	USB port	USB port			USB port
PHYSICAL CHARACTERISTICS					
Effective aperture	19 mm ϕ	19 mm ϕ			19 mm ϕ
Absorber	H9	H9			W5
Mounting holes (for post)	2 x 8-32	2 x 8-32			2 x 8-32
Dimensions	59W x 181.4L x 17D	59W x 181.4L x 17D			59W x 181.4L x 17D
Weight	210 g	210 g			210 g
ORDERING INFORMATION					
Compatible stand	STAND-S-233	STAND-S-233			STAND-S-233
Product page					

a. To get all the damage thresholds, see User Manual.
b. At maximum power.